

How to access

『 RESI STAY Hachi Inn 』

Japanese address : 〒600-8155
京都府京都市下京区西玉水町 281

Address : 281 Nishitamamizucho,
Shimogyo Ward, Kyoto, 600-8155



Map of local area



From Kyoto Station

Walk 9mins walk

Taxi About 5 min. ~

How to check-in

『 RESI STAY Hachi Inn 』

■ Entrance door password

Please enter password here.

See attachment



Entrance



The room door locks automatically, so please be careful not to forget the passwords during your stay.

■ How to unlock / lock the room door

Password

See attachment

① How to unlock the room door

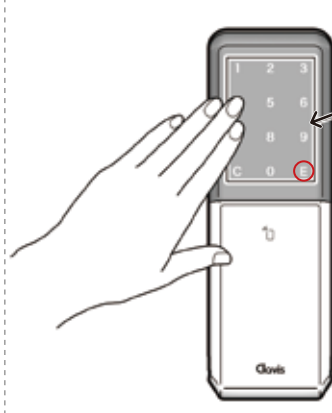

Touch the black screen once.
The number will be displayed.
Enter the PIN to unlock the device.

***If the password is wrong five times in a row, an alarm buzzer will sound and the device will be inoperable for one minute.**

② How to lock the room door

*** Room doors do not lock automatically.**

From inside the room

Turn the knob while pressing it to lock.

***The same applies when opening the door.**

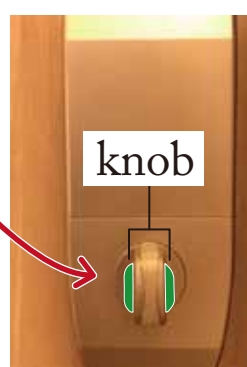

From outside your room

① Touch the black screen once.
The number will be displayed.

② Touch again to sound and lock the door.

***Please confirm that the door does not open.**

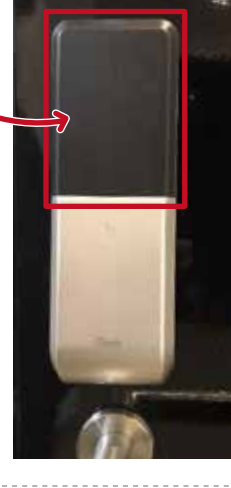

■ Check in / out

Check in time

3PM~

Check out time

~10AM

When checking out, please make sure to put red tag in the room into the box at the Entrance.



Entrance

Direct Phone

Return Box



Please be sure to check out by 10 AM on the date of your departure. **If guests continue to use the room after check-out time, they will be charged the room fee for an additional night.**

■ CONTACT US

• DIRECT PHONE to call the Reception Counter (8AM to 8PM)

If you have any questions during your stay, please use the phone located at the Front Entrance of the building. The phone connects directly to the Reception Counter.

• OTHER CONTACT INFORMATION (8AM to 8PM)

RESI STAY Reception Counter

• Tel : +81-75-353-7744

• E-mail : info@resistay.jp

[For emergencies after 8 PM]

Press [3] button on the direct phone.

If you use your personal phone,

please call +81-70-1804-6888.

■ EMERGENCY CALL



Police **110**

Ambulance / Fire **119**

! Nuisance

Please be considerate of the neighbors by keeping quiet late at night and early in the morning.

In the case of excessive noise or drunkenness that causes nuisance for other guests and neighbors, it may result in the cancellation or cutting short of your stay.

■ Other Contact Information

RESI STAY

Chatbot

Our chatbot's here 24/7 to help you !



<https://obot-ai.com/bot/resistay/>

House Rules

『 RESI STAY Hachi Inn 』

■ Wi-Fi 📶

The Wi-Fi password is listed on the acrylic stand in your room, so please check it.

■ Cleaning 🧹

There is no daily house keeping during your stay. If rubbish accumulates, please dispose of it in the rubbish dump outside.

A laundromat is available on the first floor.

■ Maintenance ✂️

Staff members may sometimes enter your room for maintenance purposes during your stay. You will be notified in advance. We appreciate your understanding and cooperation. There is a safety box in your room for your valuables.

■ Rubbish 🗑️

Trash bins and garbage bags are provided in your room.

Please separate your garbage into two types:

- ① Cans, glass bottles, and plastic bottles
- ② Household waste

When your room's trash bin is full, please take your garbage to the large container located outside the building. After placing your garbage in the large container, please make sure to close the lid. Do not dispose of trash on the street or in bins belonging to other buildings.



■ Prohibited acts 👤+✂️

- Even if it is just for a short period of time, bringing non-registered guests into the room or building is prohibited.
- Please do not move beds in your room for safety reasons.

■ Security 🔒

For security purposes, when leaving your room at any time, please make sure to lock your room door and take your valuables with you.

■ Special request

During your stay, if you or someone you are traveling with becomes ill with the flu or a similar illness, please contact the Reception counter.

We would like to take special steps during our cleaning process in order to prevent the spread of illness. Thank you for your cooperation.

Items Subject to Additional Charges

『RESI STAY Hachi Inn』

Smoking

There is no smoking inside the guest rooms, balcony, nor on the streets surrounding the building. If guests smoke inside the building or on the streets around the accommodation, there will be a fine of 10,000 yen.

*Please smoke only in the designated smoking areas listed in the QR code on the right.

Kyoto City
Public Smoking area



Rubbish

Please bring all your personal belongings home. A disposal fee of 10,000 yen will be charged for bulky items such as strollers, suitcases, etc. that are left at the accommodation.

Do not throw your rubbish on the road or in the trash cans of other buildings.

Lost and Found

If you have forgotten an item in your room, we will keep it for two weeks. We can forward forgotten items to you. We can forward forgotten items to you by charging delivery fee and commission fee (1,000 yen per delivery) .

*If we do not hear from you in regards to the items, we will dispose of them.

Car and Bicycle Parking

RESI STAY accommodations do not have parking or bicycle parking facilities. If you are renting a car, please use a paid parking space. To avoid causing inconvenience to the local residents, please do not park your car or bicycle in any area other than paid parking lots or bicycle parking facilities.

If your vehicle is found parked in unauthorized areas, a fine of 30,000 yen will be charged.

Penalties will also apply for parking in prohibited or legally restricted areas.

We want to express our deepest gratitude to our guests for choosing to stay with RESI STAY.
We hope you have a pleasant stay with us.

*For the improvement of our services,
we kindly ask for your cooperation in
posting a review on the booking site
you used.*

For information about RESI STAY accommodations and the surrounding area, please refer here.

Official website
<https://resistay.jp/>



Instagram
KYOTO_RESISTAY

